

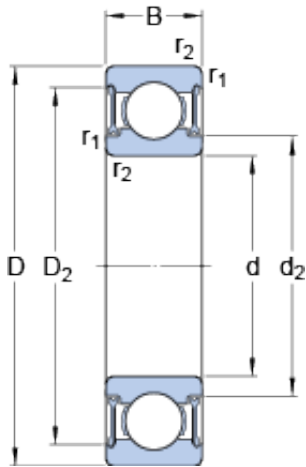

BEARING-SINGAPORE (PTE)LTD.



12 mm x 21 mm x 5 mm SKF W 61801-2RZ
deep groove ball bearings

Bearing No. W 61801-2RZ

W 61801-2RZ Bearing 2D drawings and 3D CAD models

Size	21x12x5 mm
Bore Diameter	12 mm
Outer Diameter	12 mm
Width	5 mm
d	12 mm
D	21 mm
B	5 mm
d ₂	13.8 mm
D ₂	19.15 mm
r _{1,2} - min.	0.3 mm
D _a - max.	19.5 mm
r _a - max.	0.3 mm
Basic dynamic load rating - C	1.5 kN
Basic static load rating - C ₀	0.9 kN
Fatigue load limit - P _u	0.039 kN
Reference speed	70000 r/min
Limiting speed	36000 r/min
Calculation factor - k _r	0.02
Calculation factor - f ₀	13.4
d ₂	13.8 mm
D ₂	19.15 mm
r _{1,2} min.	0.3 mm
d _a min.	13.5 mm
d _a max.	13.5 mm



BEARING-SINGAPORE (PTE)LTD.

D_a max.	19.5 mm
r_a max.	0.3 mm
Basic dynamic load rating C	1.51 kN
Basic static load rating C_0	0.9 kN
Fatigue load limit P_u	0.039 kN
Calculation factor k_r	0.02
Calculation factor f_0	13.4
Mass bearing	0.006 kg