

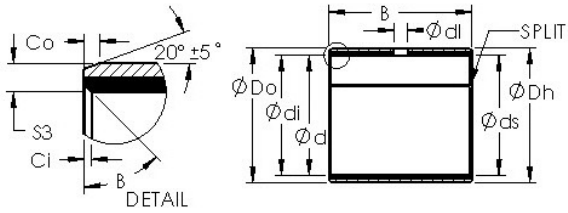

BEARING-SINGAPORE (PTE)LTD.



AST AST50 68IB32 plain bearings

Bearing No. AST50 68IB32

Bore Diameter	107,95 mm
Bearing Type	straight
Shaft Dia., Nominal (d)	4.2500
Shaft Size (ds) - 4.25	4.2478
Housing Bore Dia. (Dh) - 4.4372	4.4358
Bearing Bore after Mounting (di) - 4.2568	4.2502
Average Clearance (Cd)	0.0046
Wall Thickness (S3)	0.095
Bearing Length, Nominal (B)	2.000
Bearing Length Tolerance (B tol.) - +.010 / -0.010	+.010 / 0.010
OD Chamfer Length (Co)	0.072
ID Chamfer Angle (B deg.)	30
ID Chamfer Length (Ci)	0.031
Material	Carbon steel shell with PTFE / Fiber lining

AST50 68IB32 Bearing 2D drawings and 3D CAD models