

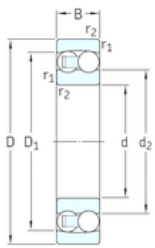

BEARING-SINGAPORE (PTE)LTD.



Cylindrical bore



Tapered bore

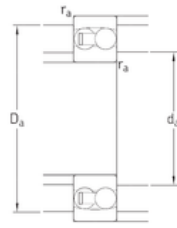

100 mm x 180 mm x 34 mm SKF 1220K self aligning ball bearings

Bearing No. 1220K

1220K Bearing 2D drawings and 3D CAD models

Size	100x180x34 mm
Bore Diameter	100 mm
Outer Diameter	180 mm
Width	34 mm
d	100 mm
D	180 mm
B	34 mm
C	34 mm
d2	127 mm
r1 min.	2,1 mm
r2 min.	2,1 mm
D1	159 mm
da min.	112 mm
Da max.	168 mm
ra max.	2 mm
Weight	3,7 Kg
Basic dynamic load rating (C)	68,9 kN
Basic static load rating (C0)	30 kN
Fatigue load limit (Pu)	1,29
Reference speed	7500 r/min
Limiting speed	4800 r/min
Calculation factor (e)	0,17
Calculation factor (kr)	0,04
Calculation factor (Y0)	4
Calculation factor (Y1)	3,7



BEARING-SINGAPORE (PTE)LTD.